

SOUTH LAKE CENTRE



Southaven, Mississippi

PROJECT:

South Lake Centre is strategically located on the southeast corner of Goodman Road (Hwy.302) and I-55 in Southaven, Mississippi, and is immediately adjacent to a Wal-Mart Supercenter and Southaven Towne Center. With its dramatic architecture and excellent visibility, South Lake Centre capitalizes on a strong mix of retailers, including *Office Depot*, *Old Navy*, *Sports Authority* and *Marshalls*. Additional area retail includes *Target*, *Home Depot*, *Lowe's*, *JCPenney*, *Dillard's*, *Circuit City*, *Linens N Things*, *Kohl's*, *Kroger* and *Schnucks Supermarkets*.

TRAFFIC COUNTS:

(Average Daily Count)

Hwy 55	55,000 cars/day
Goodman Road	41,000 cars/day

DEMOGRAPHICS:

	3 Mile	5 Mile
2006 Estimate Population	48,328	96,855
Average H.H. Income	\$56,918	\$57,156
Average Age	31	32

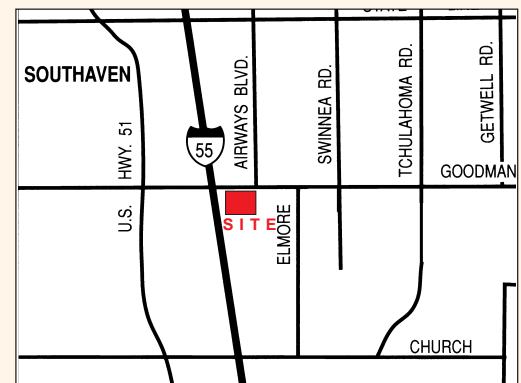

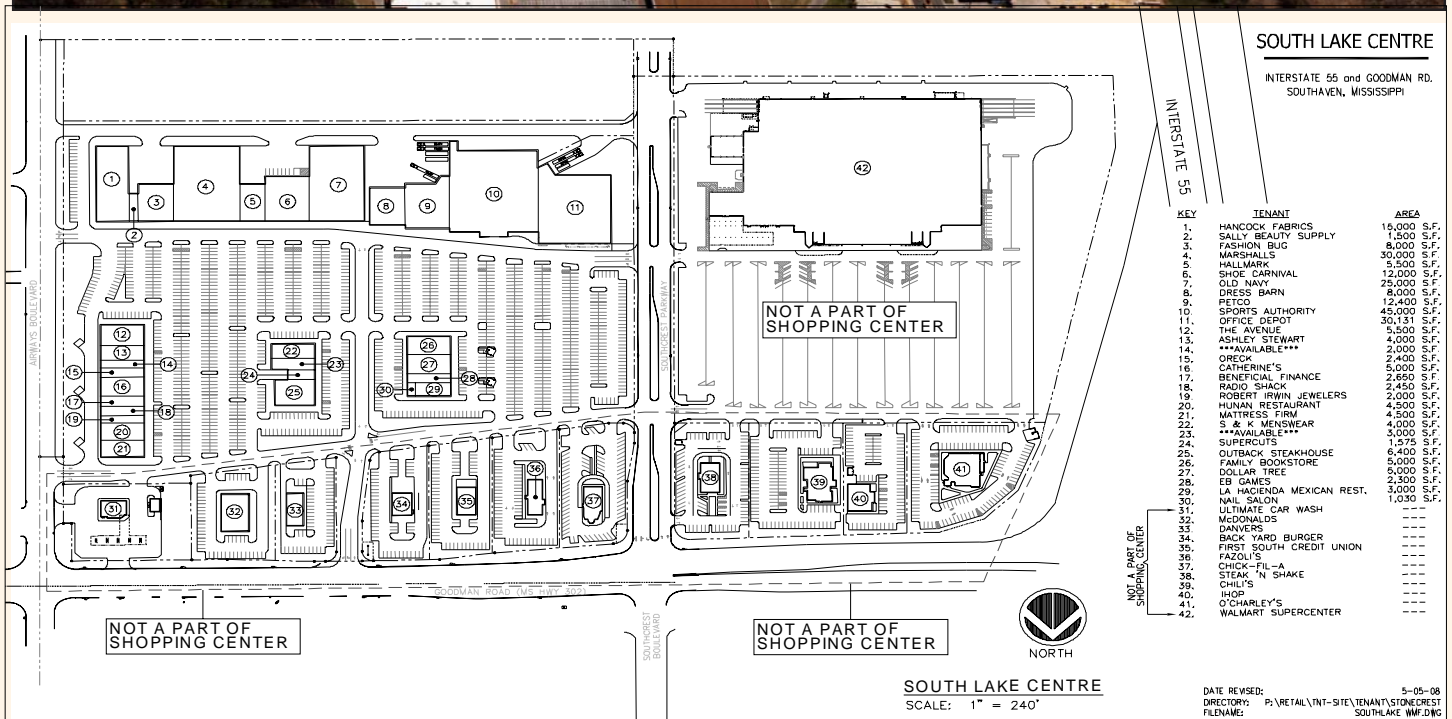

STONECREST

Investments

For more information, contact: Jason Polley at 901-682-7373 - jdp@stonecrestinvestments.com
 5350 Poplar Avenue, Suite 312, Memphis, Tennessee 38119 - www.stonecrestinvestments.com